

The FR3 crossover motorhome combines the best features, family friendly livability and affordability of an easy to drive Class C motorhome with the space, convenience and styling of a Class A motorhome.

The FR3 crossover motorhome offers flush floor construction for a smooth transition from the cockpit to the living area. Driver and passenger seats have the ability to become part of the entertainment rooms with an easy swivel. The carpet-free surface also provides a pet-friendly environment. Radius ceilings throughout the coach increase headroom for a more open, relaxed living space. Contemporary furnishings and deep 32" sliderooms with attractive woodgrain enhance the residential appeal. Upgraded LED interior lighting throughout extends the life of your battery substantially.

The media center provided in the dash includes an AM/FM/CD/DVD/Bluetooth/USB that can stream music from a smart phone or bluetooth-capable device indoors or out. The kitchen includes a deep double bowl stainless steel sink, microwave, 3-burner cooktop and a large oven. Oversized dinette seating and windows offer an excellent view with side windows in the deep slideout for cross-ventilation.

The FR3 crossover motorhome features a well-lit bedroom with a large rear window for plenty of natural light and a reading light over the King-sized bed [72" x 80" residential bed].



28 DS



Let the vacation begin
at your front door.

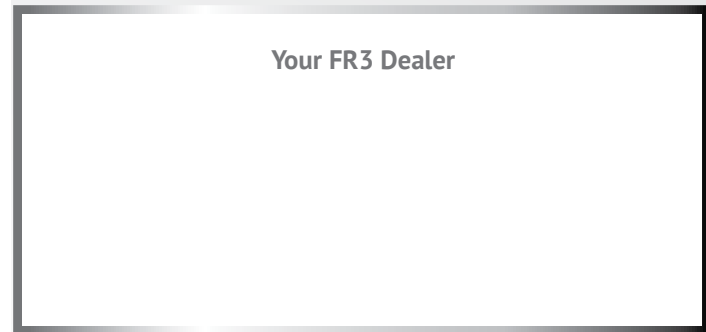

Forest River, Inc.
FR3 Division
58277 State Rd. 19 South
Elkhart, IN 46517
(574) 296.7700

www.forestriverinc.com/fr3



PRE-DELIVERY INSPECTION FACILITY

20,000 square feet of quality assurance. The bare essentials for a premium product. This state-of-the-art facility gives immediate daily feedback to production for quality assurance in every unit built.



Forest River, Inc. encourages our customers to purchase their Forest River products from a local dealership whenever possible for the following reasons:

- 1) Forest River, Inc. dealers are independently owned and operated businesses so priority service and scheduling is at their discretion and is often provided to customers that purchased their unit at that dealership.
- 2) Purchasing locally allows customers to establish meaningful relationships with a dealer, enhancing the RV experience through assistance with product questions, user tips or RV regulations for your state or country, and much more!
- 3) Canadian customers must meet requirements to bring an RV purchased out of the country to their home. These requirements may involve additional inspections and certifications, taxes and fees. Your local Canadian Dealer is a professional at meeting these requirements.
- 4) Scheduling timely warranty repairs and adjustments through a local dealership provides far greater flexibility and convenience to you, the customer!

It is the goal of Forest River, Inc. that all of our RV owners fully enjoy the RV experience and that customer satisfaction meets or exceeds their expectations!

24/7 EMERGENCY ROADSIDE ASSISTANCE

For a worry-free ownership experience

Forest River includes one

year of Coach-Net RV Technical & Roadside

Assistance with each RV purchase. Whether

new to the RV lifestyle or an experienced RV enthusiast,

Forest River owners have 24/7 access to technical,

operational and emergency road service

coverage throughout the US & Canada.

Coach-Net's fast, dependable

service is just a phone

call away.

Coach-Net®
RV Technical & Roadside Assistance



Learn More
Scan this barcode using
a QR Reader on your
smart phone to learn
more about Forest River.



All information contained in this brochure is believed to be accurate at the time of publication. However, during the model year, it may be necessary to make revisions and Forest River, Inc. reserves the right to make all such changes without notice, including prices, colors, materials, equipment and specifications as well as the addition of new models and the discontinuance of models shown in this brochure. Therefore, please consult with your Forest River, Inc., dealer and confirm the existence of any materials, design or specifications that are material to your purchase decision. 08/15 20K

©Copyright 2015 Forest River Inc - All Rights Reserved.



Class C Floorplans, Class A Styling

28 DS shown with Carmel interior



30 DS shown with Mocha interior



Styling Appointments

FR3's crossover styling offers even more room for your sleepy guests by offering large 32" deep slideout rooms that accommodate a deep wrap-around booth dinette and large Hide-A-Bed sofa with integrated footrest [A1, A2]. A power front bunk is hidden against the ceiling above the driver/passenger seats. With the push of a button, you can convert your Class A motorhome into the styling of a Class C motorhome up front [B].

The ergonomic cockpit cab area [B] features both a power front sun visor and manual pull-down side shades for extra privacy and comfort. The molded automotive style dash has an integrated side and rear vision backup camera display for enhanced safety. A pull-out laptop station with a 110v outlet for power is available at the passenger's seat.

"Super Storage" exterior cargo compartment at the rear of every FR3 model provides pass-through molded storage bins for your belongings [C].

The exterior plumbing bay is equipped with an outside shower, compartment light, black tank flush and enclosed water hook ups. Forest River, Inc.'s Arctic Package is standard on the FR3 for cold weather camping [D].



Features, Standards & Options

Construction & Exterior

- Grey Gel-Coat Sidewalls with Graphics
- One-Piece Fiberglass Front Cap
- Bi Hi/Lo Headlights
- LED Turn Signals
- Side-swing Front Grill w/Mesh Bug Shield
- Lower Fog Lights with LED Accents
- Color Back-Up & Side Cameras
- "SUPER STORAGE" Rear Pass-Through Cargo Compartment
- Rotocast Storage Boxes with Drains
- Radius Alpha SuperFlex Roof (Grey)
- Roof Ladder
- Power Patio Awning w/LED Light Strip
- Slide Room Topper Awnings
- Rubber Tread Entry Steps
- Outside Shower
- Power Entry Step
- Rubberized Entry Assist Handle
- Vacuum Bonded Construction
- Front Steel Cage

Chassis & Cockpit

- Molded ABS Automotive Dash w/Laptop Console and 110V Outlet
- Power Front Sun Shade (Windshield)
- Ultra Leather Driver/Passenger Seating w/Double Stitching
- Vinyl-Wrapped Low Profile Cockpit Engine Cover
- DASH - Bluetooth AM/FM/CD w/LCD Back-Up Color Monitor, Aux. & Speakers
- 5,000 lb. Tow Hitch with 7-Way Plug
- Automotive Style Bonded One Piece Windshield
- Black Exterior Mirrors
- 245/70R19.5 G670 Goodyear RV Tires with Valve Stem Extender
- Map Lights
- Driver Diamond Plate Floor Mat

Interior

- Assist Handle Eases Entry Into Unit
- Power Front Fold-Away Overhead Bunk w/Ladder
- 32" Side-Swing LED TV
- KING Jack™ Digital TV Antenna w/Mount & Built-in Signal Meter
- RADIUS Interior Ceiling
- Wide Wood Plank Residential Linoleum Flooring
- Pioneer Dash Entertainment System with AM/FM/DVD/Bluetooth
- 18,000 BTU Equivalent Atwood™ Quiet Air Command™ Ducted Roof A/C with Chill Construction and Heat Pump
- Black Walnut Cabinetry
- Brushed Nickel Hardware & Plumbing Fixtures

- Ultra Leather Hide-A-Bed Sofa w/Dual Footrests
- Ultra Leather Wrap Around Dinette booth w/Comfort Cushions
- Heavy Duty Full Extension Drawer Guides & Hardware Throughout
- Night Shade Window Treatments
- LED Lighting Throughout Unit

Galley

- Double Door Dometic Gas/Electric Refrigerator
- 3-Burner Cook Top w/Oven and Flush Mount Stove Cover
- Pull-out Countertop Extension (28DS & 32DS only)
- Flip-up Countertop Extension (28DS & 32DS only)
- Microwave Oven
- Large Double Bowl Stainless Steel Sink & Fixture
- Laminate Countertops
- Large Coat/Broom/Storage Closet
- Kitchen Drawers with Full-Extension Drawer Guides
- Trash Can Storage Area Below Sink

Bedroom & Bathroom

- 72" x 80" King Bed w/Headboard
- Bedroom Wardrobe
- Toilet with Foot Flush
- Stainless Steel Lavatory Sink & Fixture
- Brushed Nickel Framed Glass Shower

Safety & Convenience

- Entry Door with Deadbolt Lock
- Forest River Command Center
- Smoke, LPG, & Carbon Monoxide Detectors
- Fire Extinguisher

Electrical & Plumbing

- 4.0 KW Onan Gas Generator (N/A 32DS)
- 5.5 KW Onan Gas Generator (32DS only) includes 2nd 18,000 BTU Equivalent Atwood™ Quiet Air Command™ Ducted Roof A/C with Chill Construction and Heat Pump
- 2 Deep Cycle House Batteries
- Battery Disconnect Switch
- Emergency Start Switch
- Shore Power Electrical Cord w/Storage Compartment
- 6 Gallon Gas/Electric Water Heater
- Arctic Pack System (Heated Holding Tanks)
- 35,000 BTU Furnace

Decor

- Mocha (Standard)
- Carmel (Optional)

Option

- 18 cu. ft. Gas/Electric Refrigerator (32DS only)



4 FLOORPLANS



Crossover Motorhome

Class C Floorplans

Class C Features

Class C Price Point

Class A Styling

including exclusive ALL-NEW FR3 lighted logo windshield and LED Strip Lighting

30 DS

Specifications

	25DS	28DS	30DS	32DS
Chassis	Ford	Ford	Ford	Ford
Engine	V-10	V-10	V-10	V-10
Horsepower	362 HP	362 HP	362 HP	362 HP
Torque	457 ft-lbs	457 ft-lbs	457 ft-lbs	457 ft-lbs
Wheelbase	158"	190"	190"	228"
Fuel Tank	80 gal	80 gal	80 gal	80 gal
GVWR	16,000 lbs	18,000 lbs	18,000 lbs	20,500 lbs
GCWR	23,000 lbs	23,000 lbs	23,000 lbs	26,000 lbs
GAWR Front	8,000 lbs	8,000 lbs	8,000 lbs	8,000 lbs
GAWR Rear	12,000 lbs	12,000 lbs	12,000 lbs	13,500 lbs
Exterior Storage	75 cu ft	82 cu ft	112 cu ft	118 cu ft
Safety Belts	6	8	8	8
LP Tank	24 gal	24 gal	24 gal	24 gal
Fresh Water	57 gal	57 gal	57 gal	57 gal
Grey Tank	41 gal	41 gal	41 gal	41 gal
Black Tank	41 gal	41 gal	41 gal	41 gal
Length	26' 7"	29' 8"	31' 8"	33' 11"
Exterior Width	99.5"	99.5"	99.5"	99.5"
Exterior Height	12' 2"	12' 2"	12' 2"	12' 2"
Interior Width	95.5"	95.5"	95.5"	95.5"
Interior Height	82"	82"	82"	82"
Awning Length	12'	16'	16'	12'

Floorplans

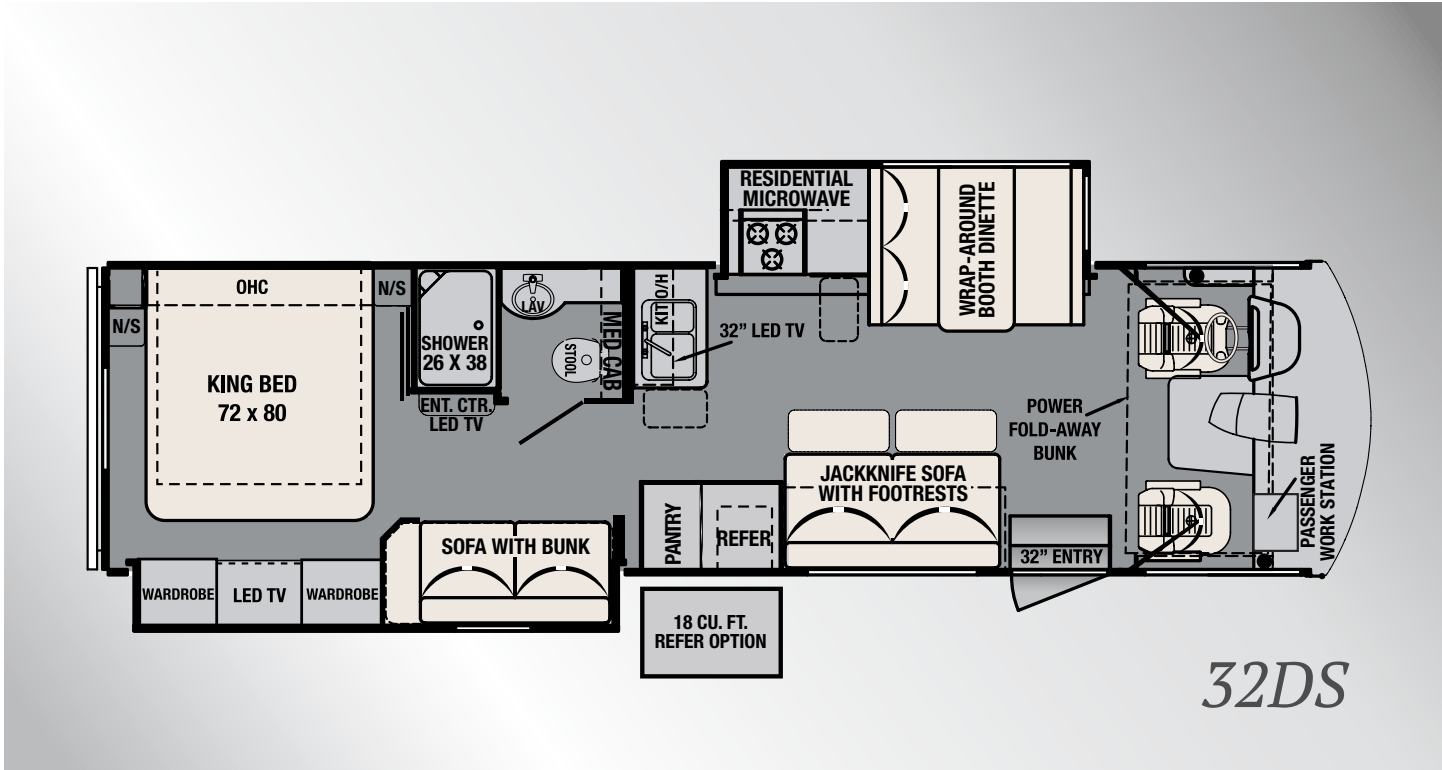
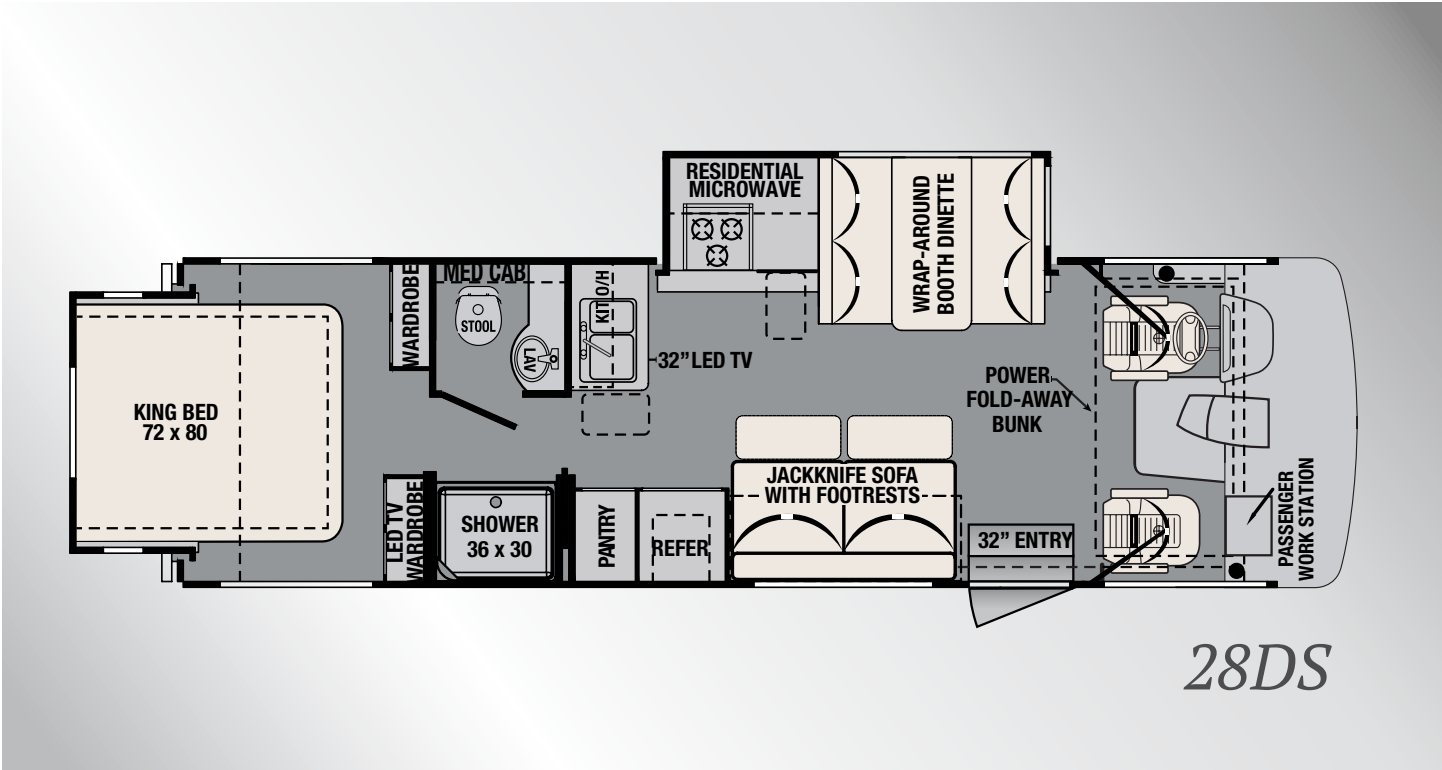
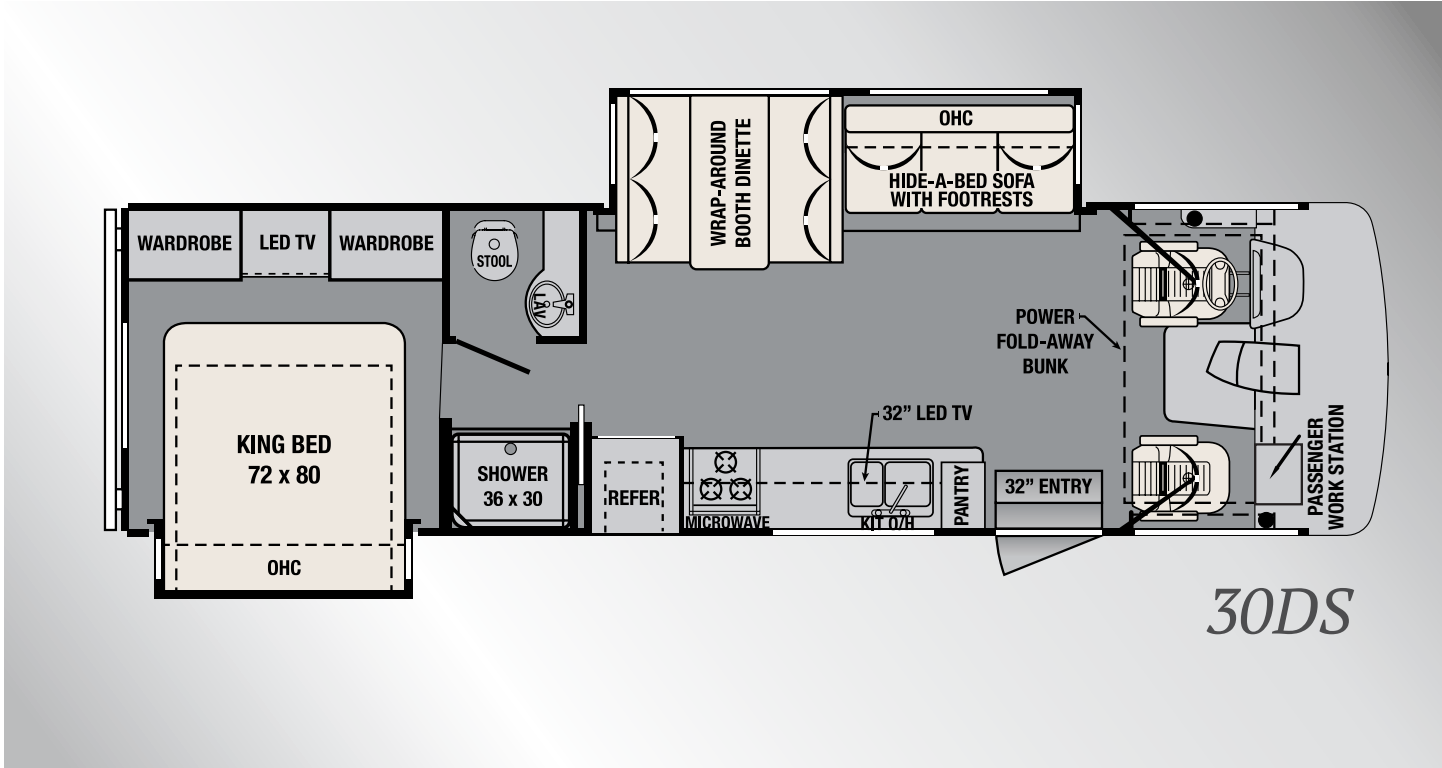
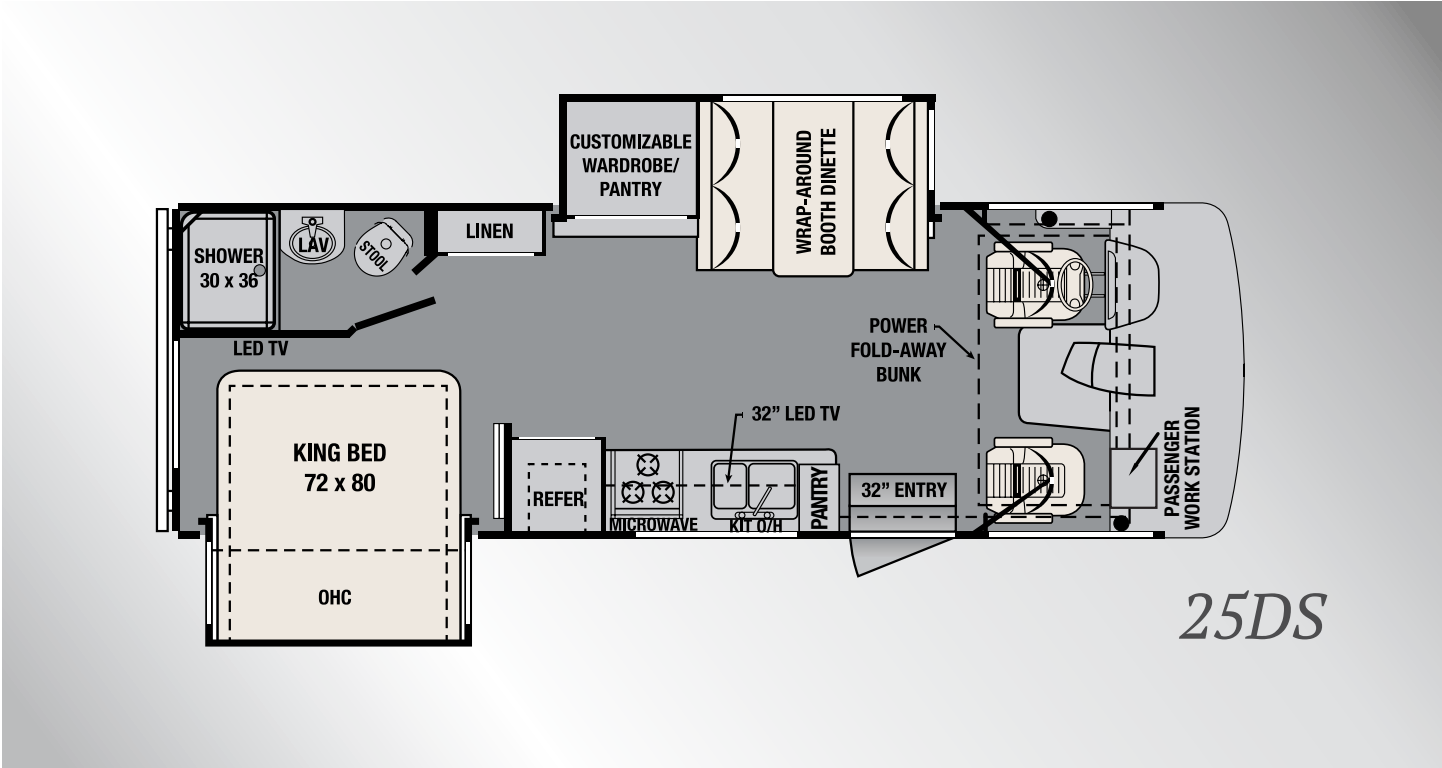

28 DS

GVWR (Gross Vehicle Weight Rating) – The maximum permissible weight of the unit, including the Unloaded Vehicle Weight (UVW) plus all fluids, occupants, cargo, optional equipment and accessories. For safety and product performance, do not exceed the GVWR.

GCWR (Gross Combined Weight Rating) – The maximum total weight of the loaded unit, plus a tow vehicle. This includes the weight of both the unit and tow vehicle, fuel for each, all other fluids, cargo, occupants, optional equipment and accessories.

GAWR (Gross Axle Weight Rating) – is the maximum permissible weight, including cargo, fluids, optional equipment and accessories that can be safely supported by each axle.

Each Forest River RV is weighed at the manufacturing facility prior to shipping. A label identifying the unloaded vehicle weight of the actual unit and the cargo carrying capacity is applied to every Forest River RV prior to leaving our facilities.